

Important Notes for Assembly:

- This manual is a generalized set of instructions for the alternator adapter that replaces any Sanden SD7 AC Compressor with a GM truck alternator (Mechman Part # 8206).
- Since this bracket has not been tested on all brackets for this AC Compressor, fitment may vary on a case by case basis, check your bracket for clearance before installation.

Included Components:



Sanden SD7 Alternator
Adapter - Front

1x



Sanden SD7 Alternator
Adapter - Back

1x

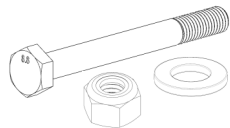

Bag of Hardware

1x

If you are experiencing problems upon installation—
DO NOT RETURN THIS PRODUCT!

Most installation problems can be easily solved.

First contact technical support at:

Service@mechman.com

1 (888) MECHMAN or 865-522-6166

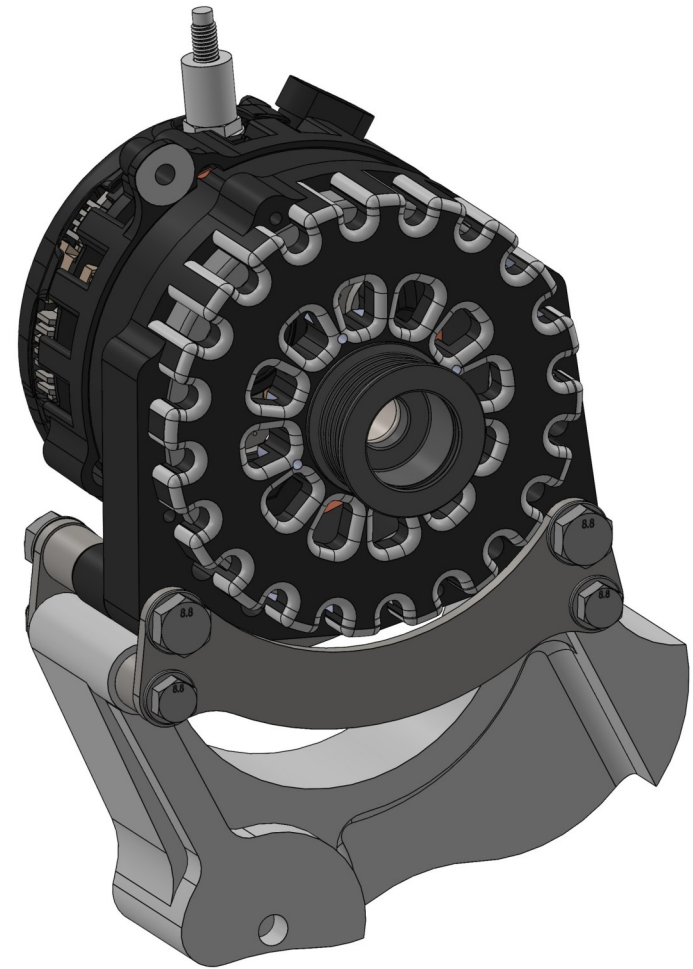

Sanden SD7 Alternator Adapter Instructions

Disassembly Instructions:

- Remove the bolts holding the Sanden SD7 AC Compressor to its bracket
- Remove the Sanden SD7 AC Compressor

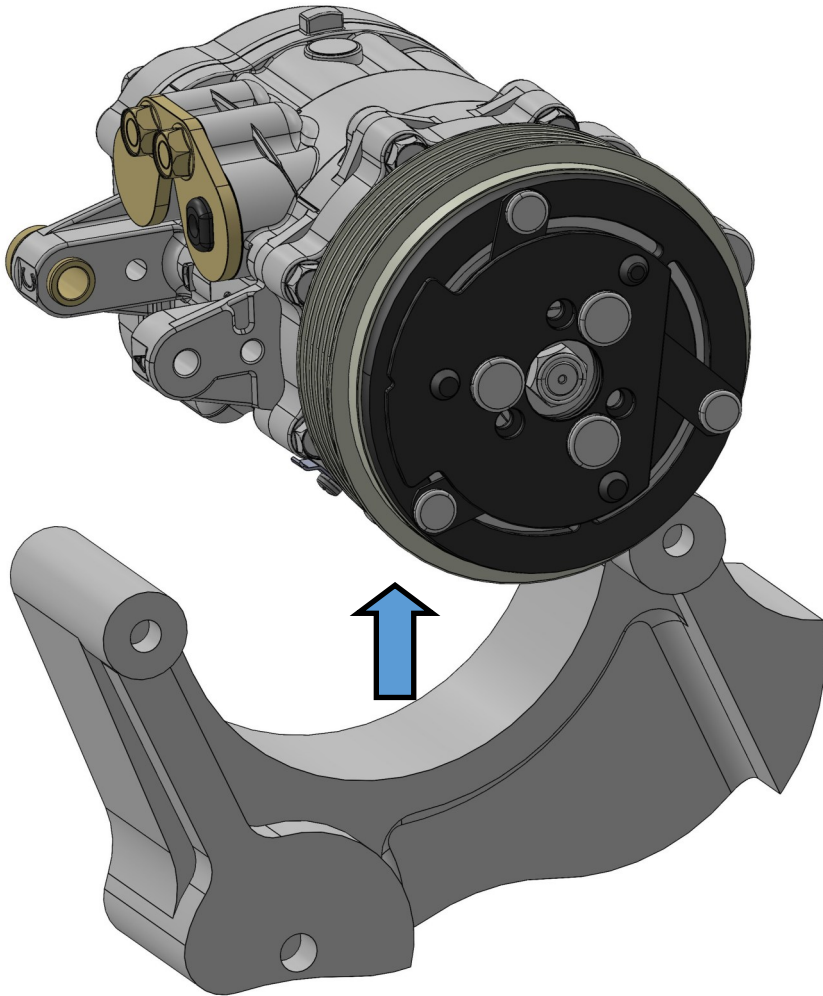

Assembly Instructions:

- Use the included M8-1.25 x 100mm Hex Bolts to attach the alternator adapter brackets to the Sanden SD7 bracket
- Use the included M10-1.5 x 100mm Hex Bolts to attach a GM truck alternator (Mechman Part # 8206).

