

Running Engine Stand



Throttle Assembly Instruction Manual

Important Notes for Assembly:

- This manual is for the Throttle add-on of the Running Engine Stand assembly. If you have not yet started with the Main Assembly instructions, start there before returning here.
- Use care when handling parts. There may be sharp edges and holes on components. Using thick protective gloves is recommended during the assembly process.
- Each bolt and nut should have the appropriately sized washer placed between the fastener and the frame.

Required Tools:

- Ratchet
- 7/16" Wrench
- 7/16" Socket
- 9/16" Wrench
- 9/16" Socket

**If you are experiencing problems upon installation—
DO NOT RETURN THIS PRODUCT!**

Most installation problems can be easily solved.

First contact technical support at:

Service@mechman.com

1 (888) MECHMAN or 865-522-6166

Included Components:

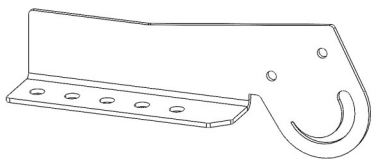

Throttle Bracket 1x

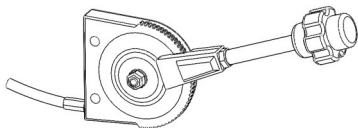

Throttle 1x

Included Hardware:

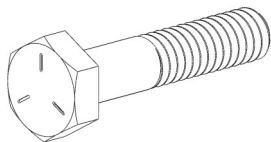

1/4"-20 x 1.25" Hex Bolt 2x

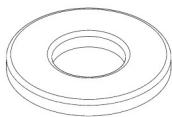

1/4" Flat Washer 4x



1/4"-20 Nylock Nut 2x

Assembly Instructions:

Step 1: Attaching the Throttle Bracket to the Assembly

Required Components:

- 1x Throttle Bracket
- **Note: This step uses hardware from Step 7 of the Main Assembly instructions and should be completed simultaneously. If these steps are already complete, remove the necessary hardware and reinstall with the added bracket in place.**
- Use the fasteners from Step 7 of the Main Assembly instructions to attach the Throttle Bracket to the Assembly.

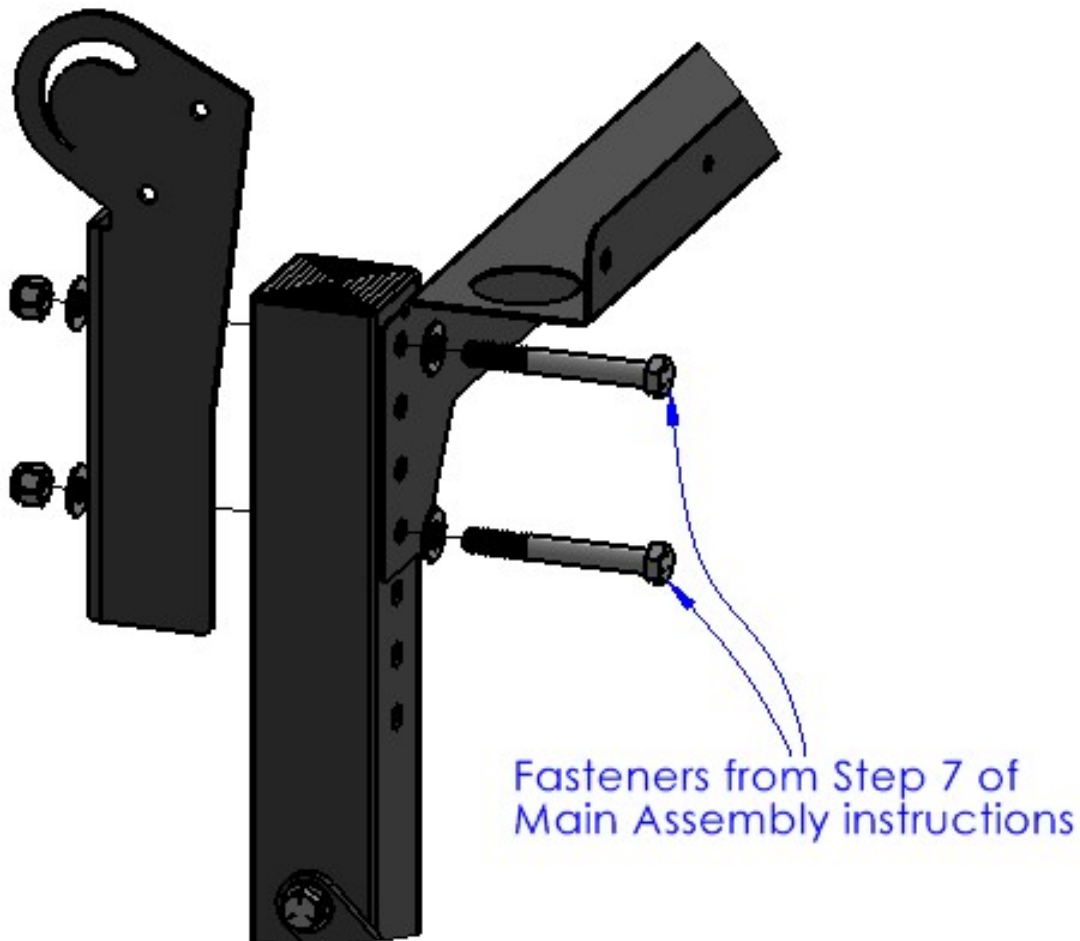

Assembly Instructions:

Step 2: Attaching the Throttle to the Assembly

Required Components: Required Hardware:

- 1x Throttle
 - 2x 1/4"-20 x 1.25" Hex Bolt
 - 2x 1/4"-20 Nylock Nut
 - 4x 1/4" Flat Washer
- Use the 1/4"-20 x 1.25" Hex Bolts to attach the Throttle to the Throttle Mount Bracket.

