

# Running Engine Stand

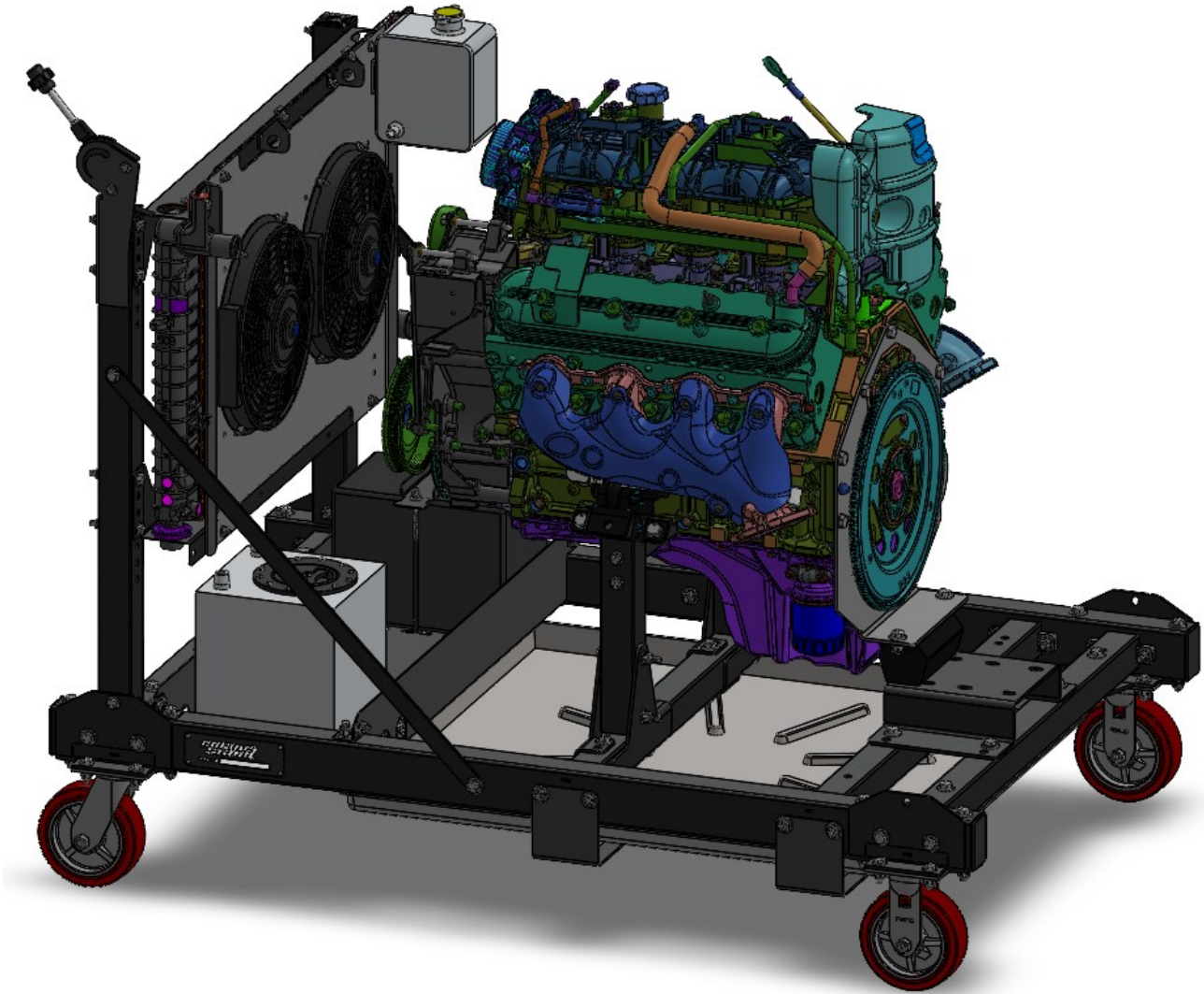

# LS Engine Assembly Instruction Manual

## Important Notes for Assembly:

- This manual is for the LS motor mount kit for the Running Engine Stand assembly. If you have not yet started with the Main Assembly or ATW instructions, start there before returning here.
- Use care when handling parts. There may be sharp edges and holes on components. Using thick protective gloves is recommended during the assembly process.
- Each bolt and nut should have the appropriately sized washer placed between the fastener and the frame.

### Required Tools:

- Ratchet
- 19mm Wrench
- 9/16" Wrench
- 19mm Socket
- 9/16" Socket
- 17mm Wrench
- 5/8" Wrench
- 17mm Socket
- 5/8" Socket

If you are experiencing problems upon installation—  
DO NOT RETURN THIS PRODUCT!

**Most installation problems can be easily solved.**

First contact technical support at:

**Service@mechman.com**

**1 (888) MECHMAN or 865-522-6166**

# Included Components:

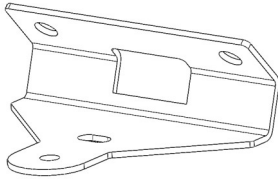

Front Engine Mount Bracket	2x
----------------------------	----

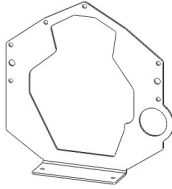

Bell Adapter Plate	1x
--------------------	----

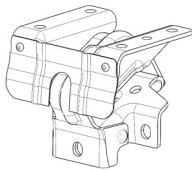

LS Motor Mount	2x
----------------	----

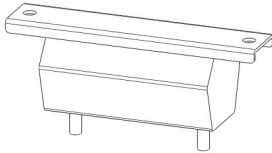

2WD Transmission Mount	1x
------------------------	----

# Included Hardware:

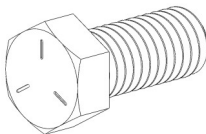

7/16"-14 x 1" Hex Bolt	2x
------------------------	----

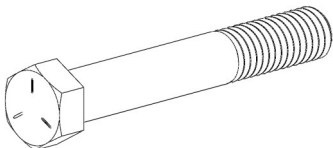

3/8"-16 x 3" Hex Bolt	4x
-----------------------	----

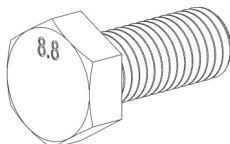

M12-1.75 x 30 Hex Bolt	4x
------------------------	----

# Included Hardware

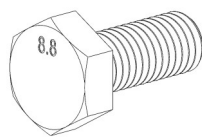

M10-1.5 x 25 Hex Bolt	14
-----------------------	----

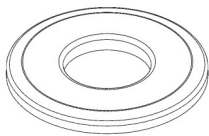

7/16" Flat Washer	4
-------------------	---

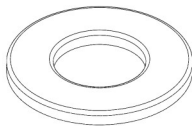

3/8" Flat Washer	22
------------------	----

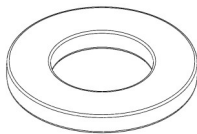

M12 Flat Washer	8
-----------------	---



7/16"-14 Nylock Nut	2
---------------------	---



3/8"-16 Nylock Nut	4
--------------------	---



M12-1.75 Nylock Nut	4
---------------------	---

# Assembly Instructions:

## Step 1: Attaching the Front Engine Mount Brackets to the Front Engine Mount Tubes

Required Components: Required Hardware:

- 2x Front Engine Mount Brackets
  - 4x 3/8"-16 x 3" Hex Bolts
  - 8x 3/8" Flat Washer
  - 4x 3/8"-16 Nylock Nuts
- Use 3/8"-16 x 3" Hex Bolts to attach the Front Engine Mount Brackets to the Front Engine Mount Tubes.

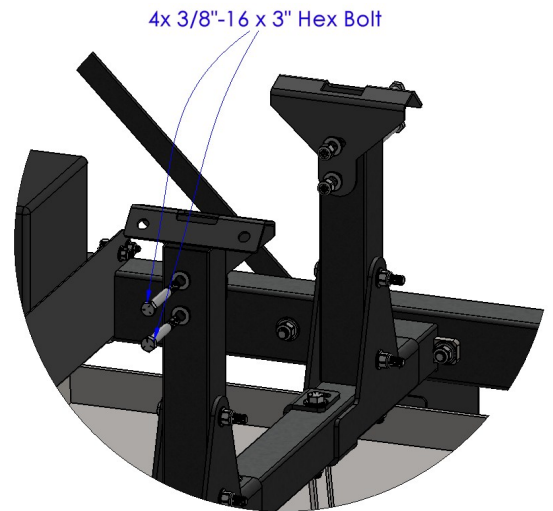

## Step 2: Attaching the LS Motor Mount to the Front Engine Mount Bracket

Required Components: Required Hardware:

- 2x LS Motor Mount
  - 4x M12-1.75 x 30 Hex Bolts
  - 8x M12 Flat Washer
  - 4x M12-1.75 Nylock Nuts
- Use the M12-1.75 x 30 Hex Bolts to attach the LS Motor Mount to the Front Engine Mount Bracket.

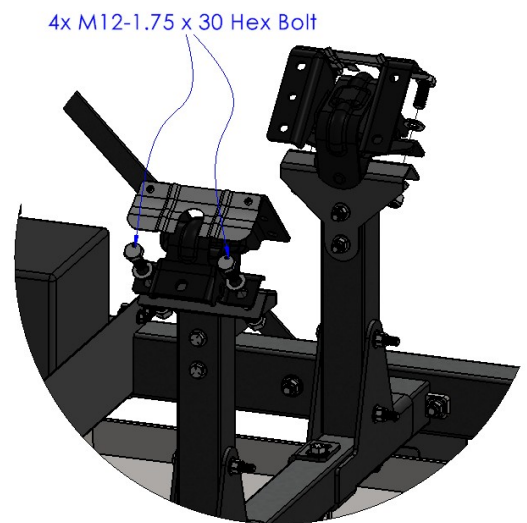

# Assembly Instructions:

## Step 3: Attaching the 2WD Transmission Mount to the Rear Engine Mount Bracket

Required Components:      Required Hardware:

- 1x 2WD Transmission Mount
- 2x 3/8"-16 Flanged Nut (Included w/ Transmission Mount)
- Use the 3/8"-16 Flanged Nuts to attach the 2WD Transmission Mount to the Rear Engine Mount Bracket.
- Note: Place the 2WD Transmission Mount in the set of slots closest to the front of the assembly.

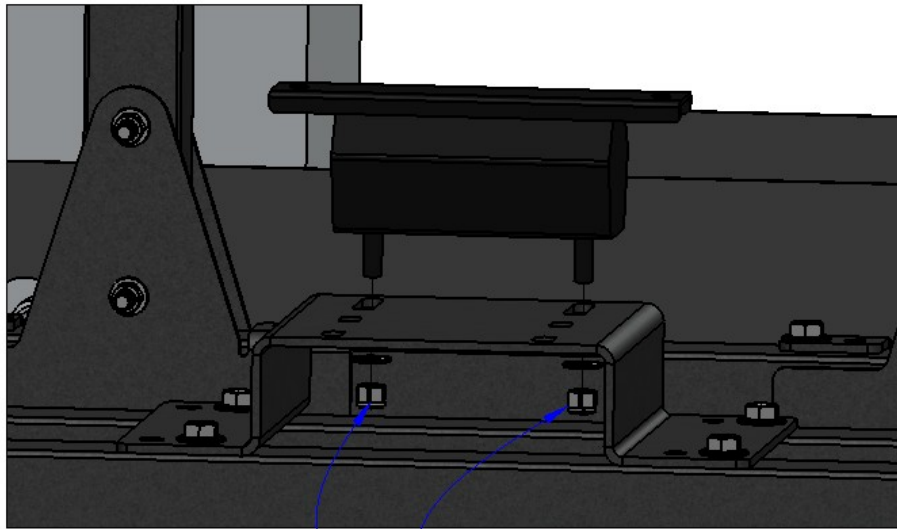

2x 3/8"-16 Flanged Nuts

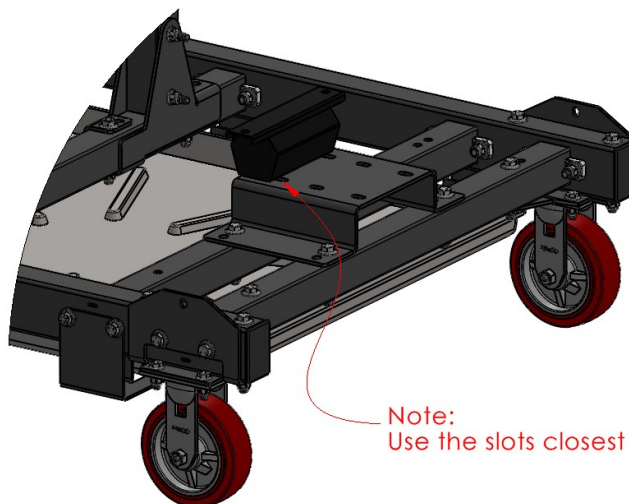

Note:  
Use the slots closest to the front

# Assembly Instructions:

## Step 4: Attaching the Bell Adapter Plate to the 2WD Transmission Mount

### Required Components:

- 1x Bell Adapter Plate

### Required Hardware:

- 2x 7/16"-14 x 1" Hex Bolts
  - 2x 7/16"-14 Nylock Nut
  - 4x 7/16" Flat Washer
- Use the 7/16"-14 x 1" Hex Bolts to attach the Bell Adapter Plate to the 2WD Transmission Mount.

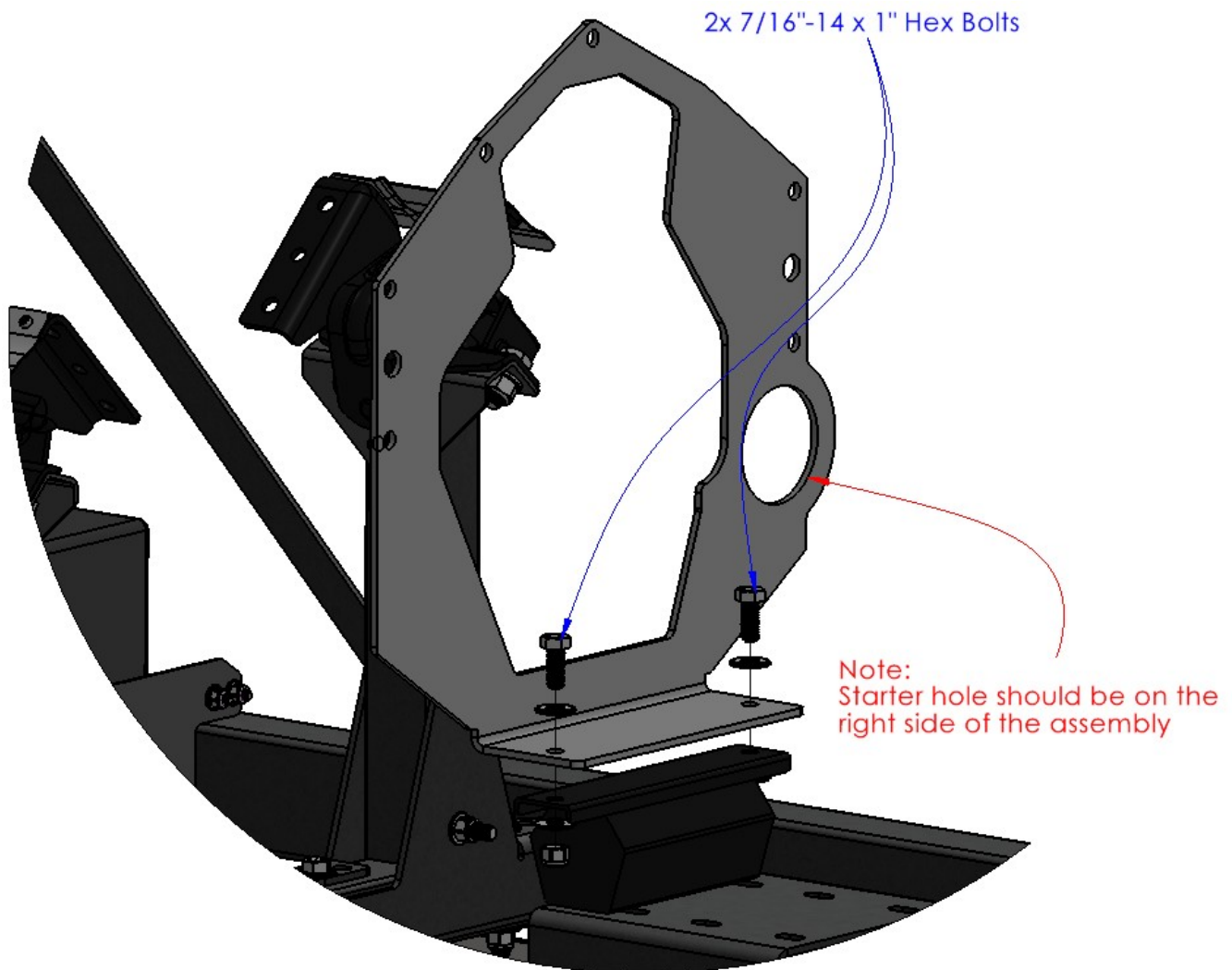



# Assembly Instructions:

## Step 5: Attaching the LS Engine to the Assembly

Required Components:

Required Hardware:

- 1x LS Engine (Not Included)
  - 14x M10-1.5 x 25 Hex Bolts
  - 14x 3/8" Flat Washer
- Use the M10-1.5 x 25 Hex Bolts to attach the LS Motor Mounts to the LS Engine, then use the M10-1.5 x 25 Hex Bolts to attach the Bell Adapter Plate to the LS Engine.
  - **Note: Attaching rubber mounts and bell adapter plate to engine before install can ease the installation.**

